

CMP/AL

Non-sparking aluminum fans for use in rooms with natural gas boilers



Low and medium pressure fans with non-sparking aluminum construction, for use in rooms with natural gas boilers according to the UNE 60601 standard, not suitable for ATEX risk areas.

Fan:

- Forward curved impeller in aluminum sheet.
- Sheet aluminium casing.
- Maximum temperature of air to be carried: -25 °C +120 °C.

Motor:

- Class F motors with ball bearings and IP55 protection.
- Single-phase 230 V 50 Hz.
- Working temperature: -25 °C +50 °C.

Finish:

- Anti-corrosive finish in polyester resin, polymerised at 190 °C, after degreasing with phosphate-free nanotechnology treatment.

On request:

- Special windings for different voltages.
- ATEX certified Category 2.



Dynamically balanced rotors with extremely robust cores

Order code

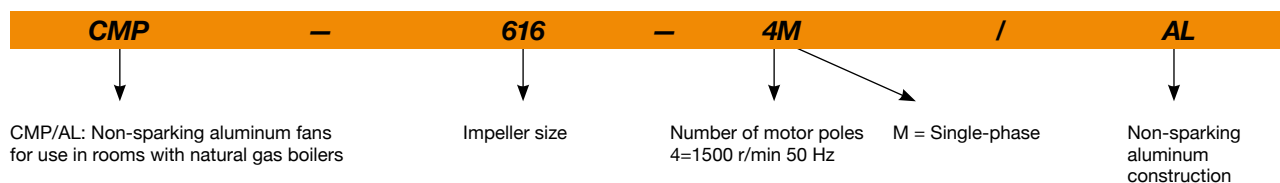

Technical characteristics

Model	Speed (r/min)	Maximum admissible current (A)	Installed power (kW)	Maximum flow rate (m ³ /h)	Sound pressure level ¹ dB (A)	Approx. weight (Kg)
		230V			Irradiated	
CMP-512-4M/AL	1370	0.83	0.09	255	44	4
CMP-514-4M/AL	1370	0.83	0.09	565	47	5
CMP-616-4M/AL	1370	0.83	0.09	850	50	8
CMP-820-4M/AL	1440	1.90	0.25	1670	55	10

1. The noise level values are pressures in dB(A) measured at a distance of 3 metres in a free field.



Erp. (Energy Related Products)

Information on Directive 2009/125/EC can be downloaded from the SODECA website or the QuickFan selector programme.

Acoustic characteristics

The values given are obtained under laboratory conditions according to ISO 3744.
Sound power spectrum $L_w(A)$ in dB(A) per Hz frequency band
 Irradiated values at maximum flow rate

	63	125	250	500	1000	2000	4000	8000
CMP-512-4M/AL	29	39	50	57	61	58	56	49
CMP-514-4M/AL	32	42	53	60	64	61	59	52
CMP-616-4M/AL	35	45	56	63	67	64	62	55
CMP-820-4M/AL	40	50	61	68	72	69	67	60

Dimensions mm

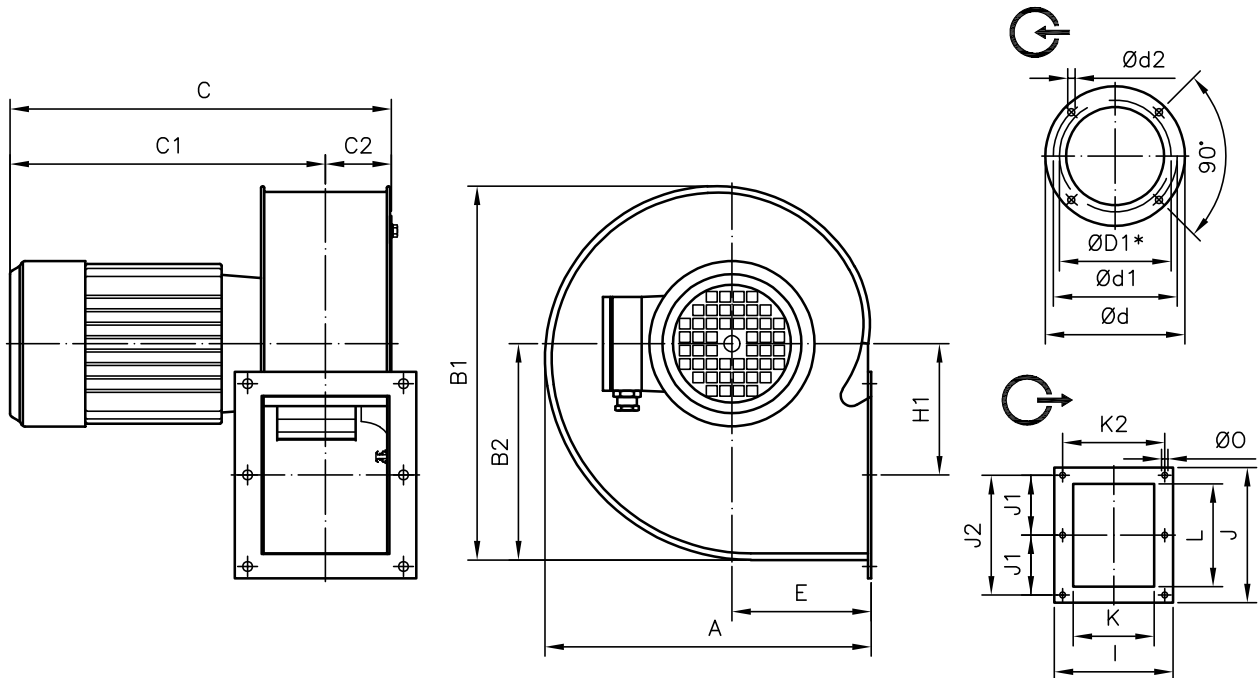

	A	B1	B2	C	C1	C2	Ød	Ød1	Ød1*	Ød2	E	H1	I	J	J1	J2	K	k2	L	ØO
CMP-512-4M/AL	185	206.5	118	255	216	39	140	132	112	M5	81	69	106	118	-	104.5	75	93	86	5.5
CMP-514-4M/AL	225	254	150	267	222	45	169	151.5	140	M5	100	91	122	147	64	128	83	105	107	6.5
CMP-616-4M/AL	258	297	173.5	289	233	56	204	180	160	M6	110	105.5	153	172	-	147	103	128	122	7
CMP-820-4M/AL	322	377	223	345.5	277	68.5	247	230	200	M6	137.5	137	184	213	94.5	189	130	160	156	9

* Recommended nominal tube diameter

Orientations

Standard supply LG 270

Positions LG 180 and RD 180 on request with special anchoring measurements.

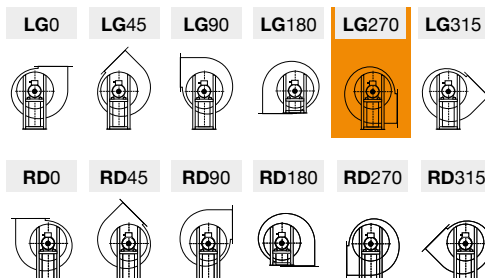

Characteristic curves

Q= Flow rate in m³/h, m³/s and cfm

Pe= Static pressure in mm H₂O, Pa and inwg

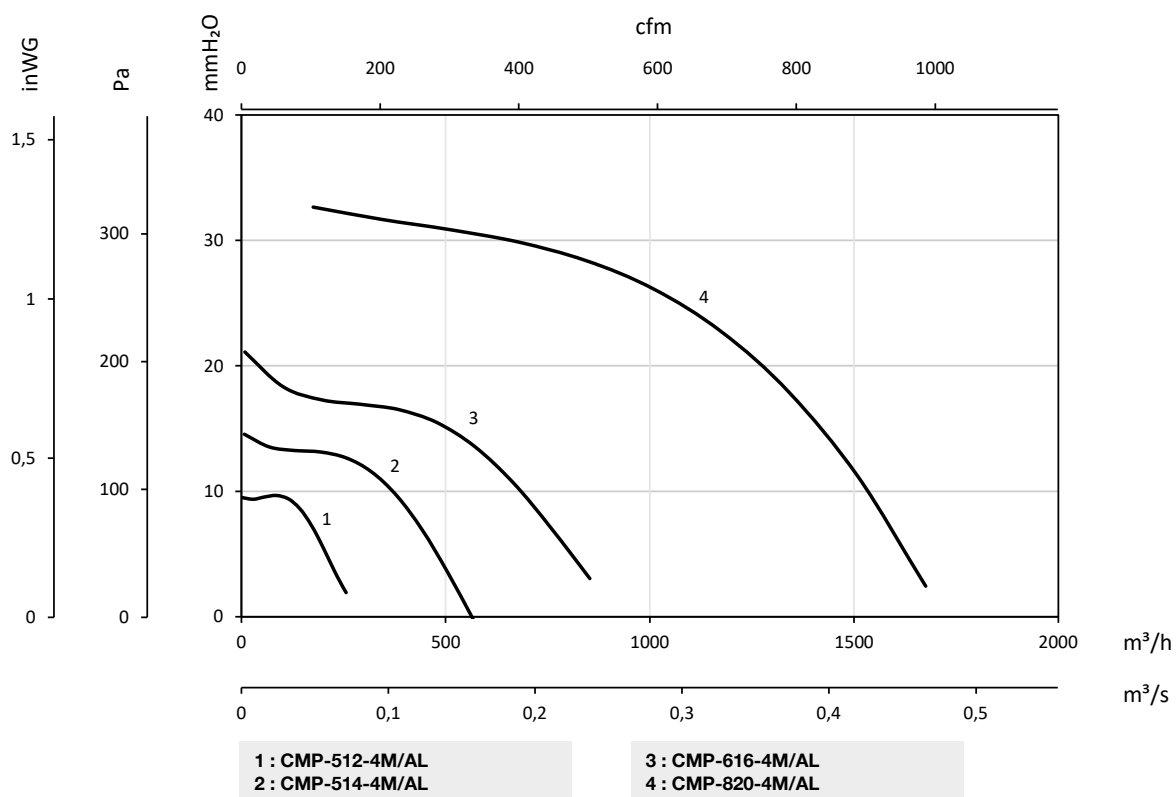

Accessories

